

**S1218 WAVE
IN STAINLESS STEEL**

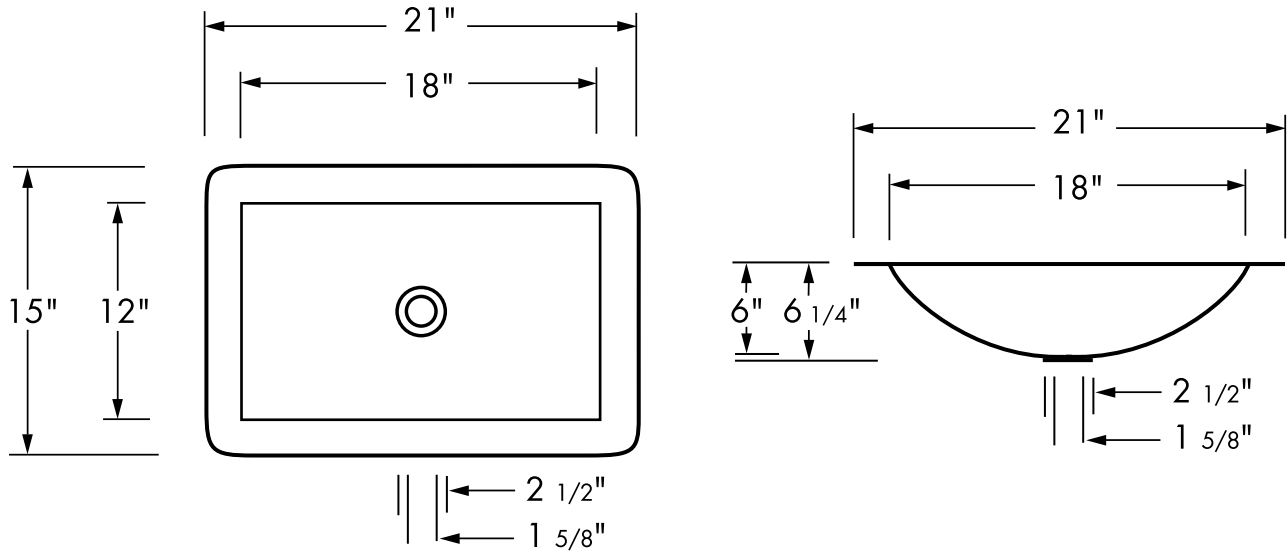

**S1218 WAVE
IN STAINLESS STEEL
16 Gauge**

DIMENSIONS:
Outside: 15" by 21"
Inside: 12" by 18"
Inside Depth: 6"
16 Gauge

IMPORTANT:

We recommend you wait for basin before making your counter top cut-out. All dimensions are approximate.

OPTIONS		
	Yes	No
Self-rimming	x	
Under Counter	x	



AND BATES

www.batesandbates.com